

Qualcomm Quick Charge is a product of Qualcomm Technologies, Inc. and/or its subsidiaries. Qualcomm is a trademark of Qualcomm Incorporated, registered in the United States and other countries. Quick Charge is a trademark of Qualcomm Incorporated.

GIGAWOOD®

6 USB Universal Charging Station

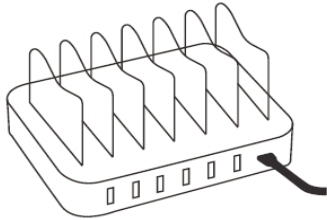

Qualcomm® Quick Charge™ Technology

Instruction Manual

Customer Support:
customersupport@gigawood.com

Package Contents

- ❖ Charging Station Base
- ❖ 7 Clear plastic dividers
- ❖ Power Cable
- ❖ This Instruction Manual
- ★ 8Pack Charging Cords: Apple 4 , Micro 2, Type C 2 / 8-12inches

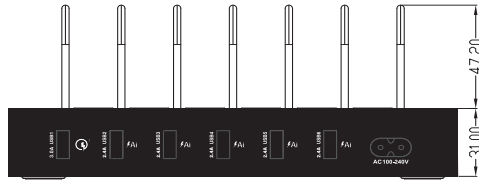

Specifications

Model number: GW-UCS612

Color: Black

Dimensions: 5.08 x 7.28 x 1.22 in

Weight: 1.1 pounds

Input: AC 100-240V; 50-60Hz

Output: DC 5V: 12A 60W Max

USB 2-6: 5V 2.4 A Max

USB 1 Quick Charge 3.0: 5V / 2.5A, 6.2V to 12V / 2.0A

Power Cable length: 5feet

One Quick Charge 3.0 Port: Ensures the fastest charging efficiency up to 80% in 35 minutes 4x faster than the conventional charger. Backward compatible with Quick Charge 1.0 and 2.0 Technology Smart IC Technology: Recognizes the electronic device and maximizes charging efficiency. Charge faster and save time. Compatible Devices: Quick Charge 3.0 Port (Max 3A Output): iPhone 8 / iPad / Tablet, Samsung Galaxy S8 S7 S6 / Edge / Edge Plus, Note 8 / Note 5 / Note 4 I Edge Google Nexus 6 Motorola Droid Turbo, Moto X 2014 Sony Xperia Z4 I Z4 Tablet, Z3 / Z3 Compact / Z3 Tablet Compact LG G4, LG G Flex2, LG V1 0 HTC One A9 / M9 / M8, HTC Desire Eye, HTC One remix Xiaomi Mi3, Mi4, Mi Note, and more Asus Zenfone 2 ZTE Axon Pro Yota Phone 2 Samsung Fast Charge Qi Wireless Charging Pad, HUAWEI MATE8 MATE9 P9 HONOR V8, V9 Five 10W USB Port (Max 2.4A Output): For all iOS, Android or Windows Smartphones/Tablets, like iPhone, iPad, Samsung, Nokia, Sony, Blackberry, LG, HTC Smartphones I Power Banks / Bluetooth Speaker & Headsets and More.

Use steps:

1. Remove the power cord and dividers from the packing box
2. According to the number of the required support, and the thickness of the device, Install dividers (see the section containing the Easy installation of the 7 dividers below).
3. Plug one end of the power cord into the product.
4. The other end of the power cord is inserted in the power socket.
5. Turn on the LED switch, the indicator light is on
6. Charging the device through the USB charging cable

LED and SLEEP mode switch

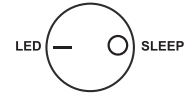

The LED switch shows the charging status of all devices. If the device is charging, the blue LED light should be on. The light stays on until the device is fully charged. If you do not want to see the blue light, you can put the switch to SLEEP mode. If you want, you can use it as a night-light. You can choose SLEEP mode for comfortable sleeping. The SLEEP switch turns off all blue charging lights. Charging continues safely even in sleep mode. When you wake up in the morning, your devices are fully charged and will be on standby to perform your click commands.

Useful Tips for Charging Problems

This product is available in the world with free voltage capability of AC100-240V 50-60HZ. Diagnose the error in the following ways: If that does not work, contact the Amazon Return Center and apply for a free replacement with the new product.

First, disconnect the AC plug from the power outlet. Then disconnect the AC power cable from the charger body and insert it completely again. The first power-on LED is on. Each USB port lights up when the device to be charged is connected. If the charge exceeds 95%, the LED will blink rapidly. 100% When fully charged, LED blinks slowly. If the LED indicator is not comfortable at bedtime, switch the switch to sleep mode. Charging will continue.

Notice; We offer an 8 pack cable for fast charging and data transfer as a bonus. Apple Lightning 4 Pack, Android Micro 2 Pack, Type-C 2 Pack Length: 25cm / 9.84

Easy installation of the 7 divider:

Step 1: First, pick one of the dividers and pin in the hole as shown below

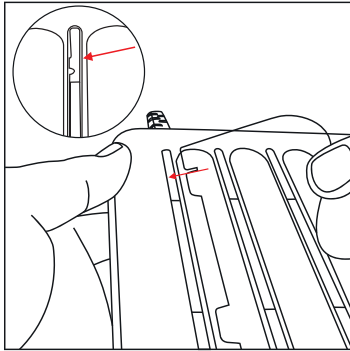

Step 2: Make sure that the pin and the hole match and press both sides of the divider as shown below to the position where you will hear a CLICK sound.

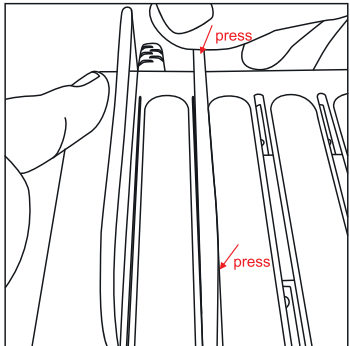

Step 3: Repeat the procedure for all the remaining dividers

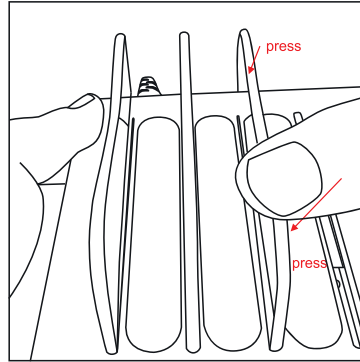

Step 4: Below is the image of the 7 dividers fixed into place using the same procedure outlined above. We can see 6 slots which means the hub can only accommodate 6 devices.

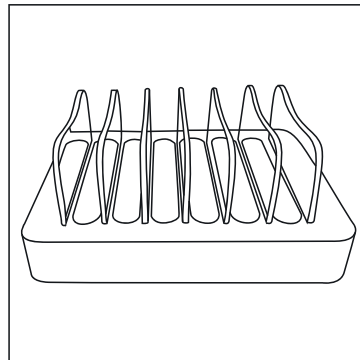

Step 5: This is how the image of the fully occupied multicharger QC should appear. This is one of the products that GIGAWOOD provides to the market. The product holds 6 devices shown below.

• **Useful Tip: Removing the 6th divider is more convenient when mounting a tablet device with a bulky case of over 1 inch.**

Considerations:

1. Please check if the supply voltage is between 100-240V before using.
2. This product is ABS material, so keep it away from fire and also do not let it fall into the water.
3. If the product is not working or damaged, please stop using it immediately.
4. Do not try to replace or disassemble any part of this product.
5. Please, keep it away from children.

Register for FREE 1-Year Warranty

In order to protect your purchase do not forget to register at:

www.gigawood.com/warranty

Please visit the GiGAWOOD homepage and apply for a one-year free product warranty. We will refund within 30 days and replace with new product in case of failure within one year.

Sharing positive shopping and product experiences will be a great help for small businesses. Amazon Product Review Link:

<https://www.amazon.com/review/create-review?asin=B075XGVJPR>

Thank you very much for choosing GiGAWOOD Fast Charging Station :)

<https://www.gigawood.com/warranty>
customersupport@gigawood.com

GIGAWOOD
Study For Best Charging Device